

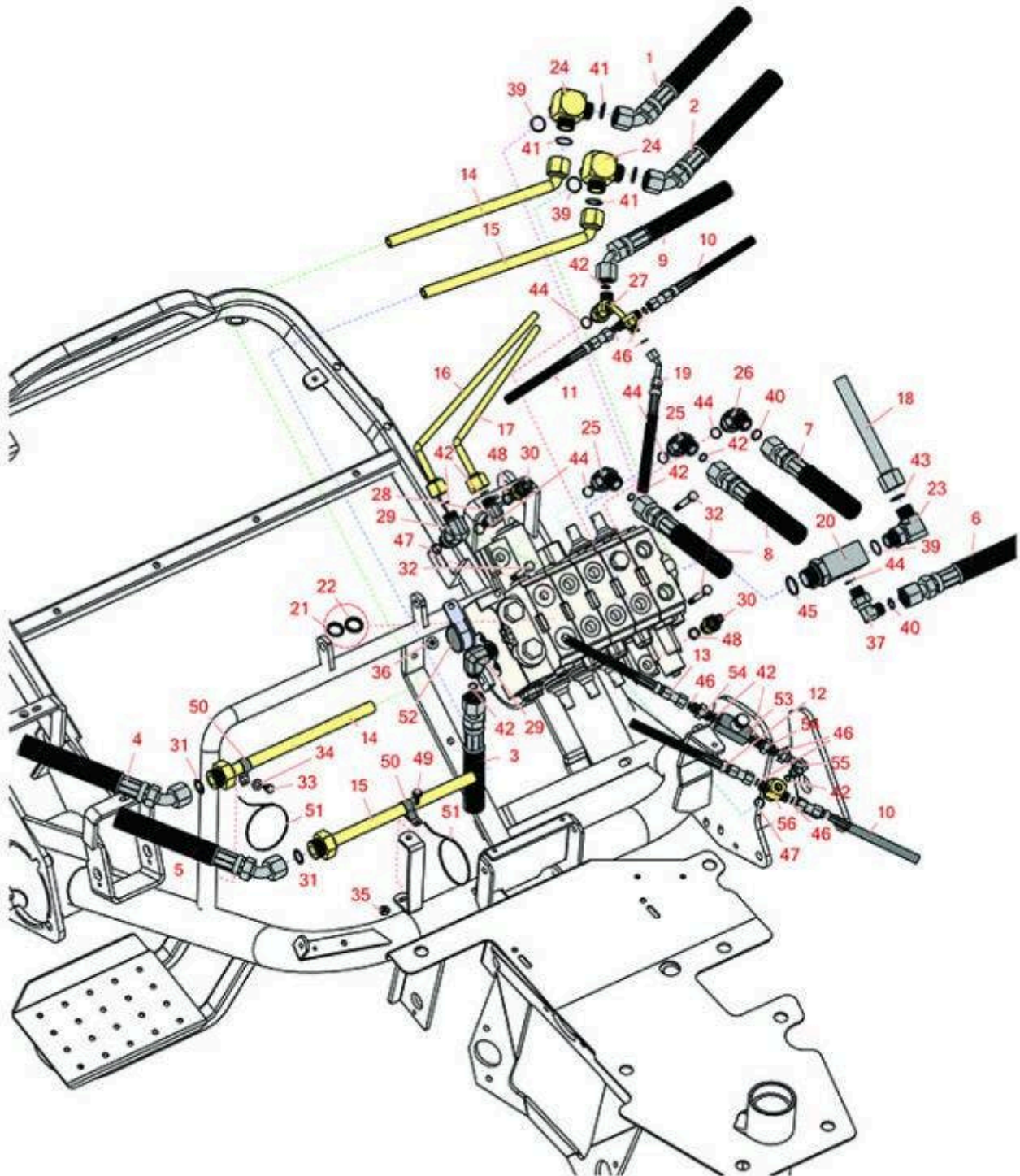

# Replaces Toro Greensmaster 3050 Parts

*Traction Unit - Model 04351*

*Control Valve*



All original equipment manufacturers names and part numbers are used for identification purposes only, and we are in no way implying that our products are original equipment parts. Prices subject to change without notice.



# Replaces Toro Greensmaster 3050 Parts

Traction Unit - Model 04351

Control Valve



| Item No   | R&R Part No.     | OEM Part No.         | Description                                  | Qty Req | Order Quantity |
|---|------------------|----------------------|--|---------|----------------|
| <b>Hoses</b>  |                  |                      |  |         |                |
| 1   | <b>R150627</b>   |                      | Hydraulic Hose Assy - Drive Motor - RH Upper | 1       |                |
| 2   | <b>R150641</b>   |                      | Hydraulic Hose Assy - Drive Motor - RH Lower | 1       |                |
| 2   | <b>R98-0647</b>  | 98-0647              | Hydraulic Hose Assy - RH Drive Motor         | 1       |                |
| 3   | <b>R150644</b>   |                      | Hydraulic Hose Assy - Valve to Pump          | 1       |                |
| 4   | <b>R150645</b>   |                      | Hydraulic Hose Assy - Drive Motor - LH Upper | 1       |                |
| 4   | <b>R98-2153</b>  | 98-2153              | Hydraulic Hose Assy - LH Drive Motor         | 1       |                |
| 5   | <b>R150642</b>   |                      | Hydraulic Hose Assy - Drive Motor - LH Lower | 1       |                |
| 5   | <b>R98-0648</b>  | 98-0648              | Hydraulic Hose Assy - LH Drive Motor         | 1       |                |
| 6   | <b>R150631</b>   |                      | Hose - Rear Motor Return                     | 1       |                |
| 6   | <b>R63-3840</b>  | 63-3840,<br>95-5987  | Hose - Rear Motor Return                     | 1       |                |
| <i>Tech Note: Hydraulic hose includes protective sleeving.:</i> |                  |                      |  |         |                |
| 7   | <b>R150626</b>   |                      | Hydraulic Hose Assy - Valve to Pump          | 1       |                |
| 7   | <b>R107-9519</b> | 107-9519,<br>98-2151 | Hydraulic Hose Assy - Valve to Pump          | 1       |                |
| 8   | <b>R150620</b>   |                      | Hydraulic Hose Assy - Valve to Pump          | 2       |                |
| 9   | <b>R95-5986</b>  | 74-3830,<br>95-5986  | Hydraulic Hose Assy - Rear Reel Motor        | 1       |                |
| 10  | <b>R150640</b>   |                      | Hydraulic Hose Assy - RH Lift Cylinder       | 1       |                |
| 11  | <b>R150632</b>   |                      | Hose - Cyl LH Drop Fits                      | 1       |                |
| 12  | <b>R150638</b>   |                      | Hydraulic Hose Assy - Front LH Cylinder      | 1       |                |
| 13  | <b>R150639</b>   |                      | Hydraulic Hose Assy - Rear Lift Cylinder     | 3       |                |

All original equipment manufacturers names and part numbers are used for identification purposes only, and we are in no way implying that our products are original equipment parts. Prices subject to change without notice.



# Replaces Toro Greensmaster 3050 Parts

*Traction Unit - Model 04351*

*Control Valve*



| Item No                      | R&R Part No.     | OEM Part No.                   | Description                       | Qty Req | Order Quantity |
|------------------------------|------------------|--------------------------------|-----------------------------------|---------|----------------|
| 14                           | <b>R70-7130</b>  | 70-7130                        | Line - Tube                       | 1       |                |
| 15                           | <b>R83-1200</b>  | 83-1200                        | Tube - LH Lower Traction          | 1       |                |
| 16                           | <b>R63-4020</b>  | 63-4020                        | Tube - Hyd                        | 1       |                |
| 17                           | <b>R63-4030</b>  | 63-4030                        | Tube - Hyd                        | 1       |                |
| 18                           | <b>R100-6431</b> | 100-6431,<br>63-4040           | Tube - Return                     | 1       |                |
| 19                           | <b>R150637</b>   |                                | Hose - Rear Lift Cyl              | 1       |                |
| <b>Other Parts Available</b> |                  |                                |                                   |         |                |
| 20                           | <b>R63-4080</b>  | 63-4080                        | Fitting - Valve Manifold - Manual | 1       |                |
| 21                           | <b>R92-2546</b>  | 92-2546                        | Wiper Seal - Control Valve        | 1       |                |
| 22                           | <b>R353-957</b>  | 353-957                        | Lip Seal - Control Valve          | 1       |                |
| 23                           | <b>R340-16</b>   | 100-8255,<br>340-16            | Hydraulic Fitting                 | 1       |                |
| 24                           | <b>R63-4050</b>  | 63-4050                        | Hydraulic Fitting                 | 2       |                |
| 25                           | <b>R340-138</b>  | 340-138                        | Hydraulic Fitting                 | 2       |                |
| 26                           | <b>R340-101</b>  | 340-101                        | Hydraulic Fitting                 | 1       |                |
| 27                           | <b>R83-1670</b>  | 83-1670                        | Fitting Assy - Special            | 1       |                |
| 28                           | <b>R340-18</b>   | 340-18                         | Hydraulic Fitting                 | 1       |                |
| 29                           | <b>R340-77</b>   | 340-100,<br>340-77,<br>95-7889 | Hydraulic Fitting                 | 2       |                |
| 30                           | <b>R83-1890</b>  | 83-1890                        | Ball Switch - Control Valve       | 2       |                |
| 31                           | <b>R150646</b>   |                                | Seal - Flat                       | 2       |                |

All original equipment manufacturers names and part numbers are used for identification purposes only, and we are in no way implying that our products are original equipment parts. Prices subject to change without notice.



# Replaces Toro Greensmaster 3050 Parts

*Traction Unit - Model 04351*

*Control Valve*



| Item No | R&R Part No.    | OEM Part No.   | Description                    | Qty Req | Order Quantity |
|---------|-----------------|--|--------------------------------|---------|----------------|
| 32      | <b>R322-14</b>  | 01-150-0830,<br>01-178-0524,<br>30-8900,<br>322-14   | Bolt - Hex HD 5/16-18 x 3 GR5  | 3       |                |
| 33      | <b>R12-3270</b> | 12-3270,<br>30-0700,<br>32104-17,<br>9266714,<br>Aug-80  | Bolt - Hex Washer 1/4-20 x 1/2 | 1       |                |
| 34      | <b>R3256-22</b> | 24-9-BD,<br>3-1032,<br>3256-1,<br>3256-22,<br>93-0954,<br>93-0989  | Washer - Flat 1/4 Yellow       | 1       |                |
| 35      | <b>R301504</b>  | 2296-42,<br>301504,<br>32127-24,<br>32128-33,<br>32146-17,<br>3296-16,<br>3296-42,<br>3296-42 ,<br>915661P | Locknut - ESNA 1/4-20          | 1       |                |
| 36      | <b>R445722</b>  | 30-8980,<br>32128-2,<br>32128-20,<br>32128-20 ,<br>445722  | Nut - Serrated Washer          | 3       |                |
| 37      | <b>R150290</b>  |  | Hydraulic Fitting - 90 Deg     | 1       |                |
| 39      | <b>R237-80</b>  | 237-80,<br>327-80  | O-Ring                         | 3       |                |
| 40      | <b>R237-30</b>  | 23-6320,<br>237-30   | O-Ring - Seal                  | 2       |                |
| 41      | <b>R237-65</b>  | 237-65,<br>237.65  | O-Ring                         | 4       |                |

All original equipment manufacturers names and part numbers are used for identification purposes only, and we are in no way implying that our products are original equipment parts. Prices subject to change without notice.



# Replaces Toro Greensmaster 3050 Parts

*Traction Unit - Model 04351*

*Control Valve*



| Item No | R&R Part No.    | OEM Part No.                   | Description                       | Qty Req | Order Quantity |
|---------|-----------------|--------------------------------|-----------------------------------|---------|----------------|
| 42      | <b>R237-22</b>  | 107-8844,<br>237-22,<br>237-78 | O-Ring                            | 5       |                |
| 43      | <b>R237-58</b>  | 237-58                         | O-Ring                            | 1       |                |
| 44      | <b>R237-79</b>  | 237-79                         | O-Ring                            | 6       |                |
| 45      | <b>R237-81</b>  | 237-81,<br>237.81,<br>327-81   | O-Ring                            | 1       |                |
| 46      | <b>R237-21</b>  | 237-21,<br>327-21              | O-Ring                            | 8       |                |
| 47      | <b>R237-42</b>  | 237-42,<br>31-4160             | O-Ring                            | 4       |                |
| 48      | <b>R38-0410</b> | 38-0410                        | Nut - Hex - 9/16-18 Thin-SS       | 2       |                |
| 49      | <b>R3234-4</b>  | 3234-4                         | Bolt - Hx Ser Was HD 1/4-20 x 3/4 | 1       |                |
| 50      | <b>R2412-41</b> | 2412-41                        | Clamp                             | 2       |                |
| 51      | <b>R3M41939</b> | 3M41939                        | Cable Ties - 8" Bulk Pkg/100      | 2       |                |
| 52      | <b>R304-61</b>  | 304-61                         | Clamp - Hose                      | 1       |                |
| 53      | <b>R150837</b>  |                                | Flow Control                      | 1       |                |
| 54      | <b>R340-92</b>  | 340-92                         | Hydraulic Fitting - Striaight     | 2       |                |
| 55      | <b>R150839</b>  |                                | Hydraulic Fitting - 90 Deg        | 1       |                |
| 56      | <b>R150838</b>  |                                | Fitting - Special                 | 1       |                |

All original equipment manufacturers names and part numbers are used for identification purposes only, and we are in no way implying that our products are original equipment parts. Prices subject to change without notice.