

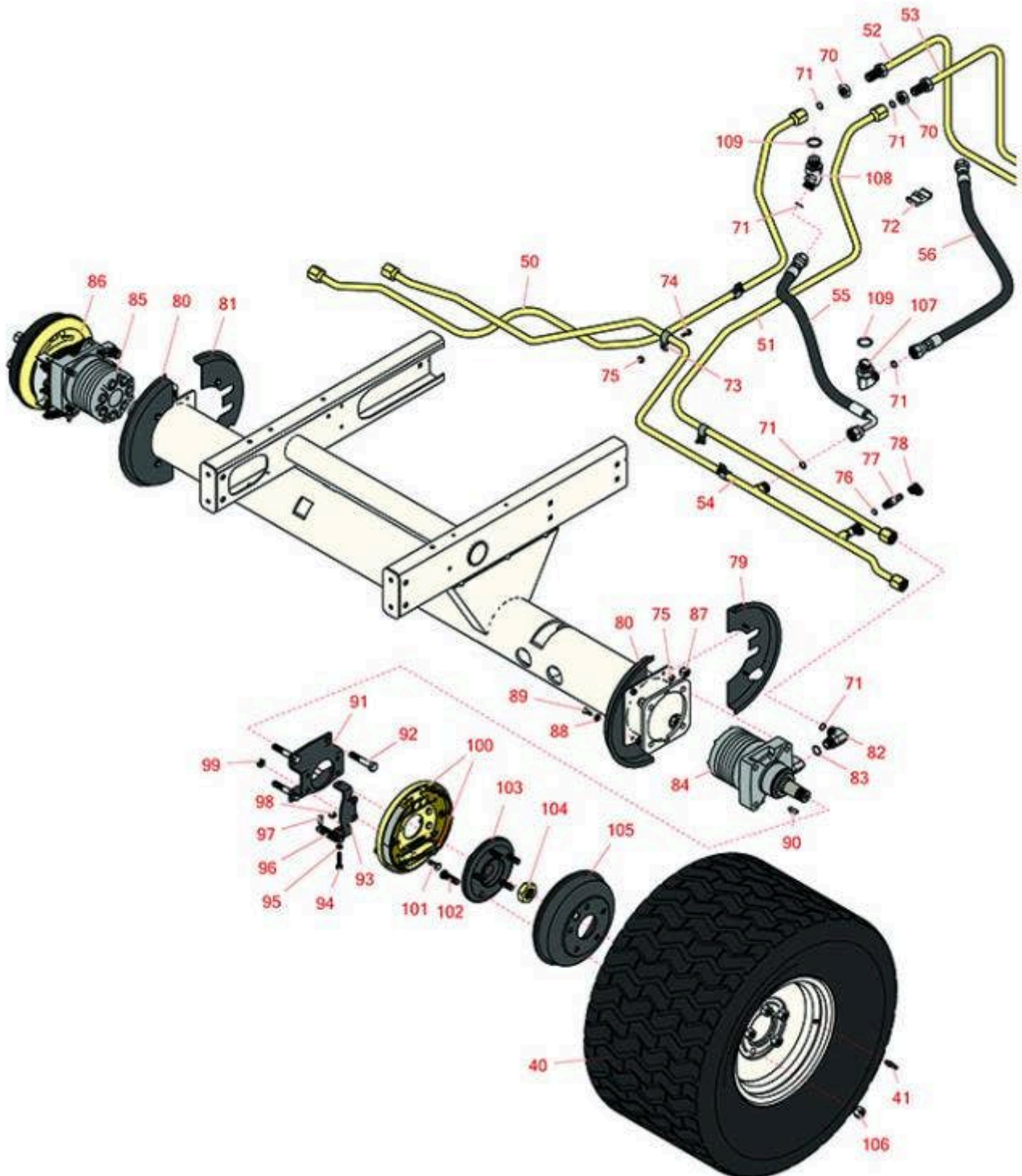

Replaces R&R Products Reel Max 744LP

Parts

Traction Unit
Front Wheel 4WD



All original equipment manufacturers names and part numbers are used for identification purposes only, and we are in no way implying that our products are original equipment parts. Prices subject to change without notice.



Replaces R&R Products Reel Max 744LP

Parts

Traction Unit
Front Wheel 4WD



Item No	R&R Part No.	OEM Part No.	Description	Qty Req	Order Quantity
Tires					
40	RCT529386		Tire - 26.5x14.00-12 Nhs (4 Ply) Carlisle Ultra Trac	2	
41	R232-27	R232-31, R360111	Stem - Valve w/ Cap	2	
Hoses and Tubes					
50	R108-7622		Tube Assy	2	
51	R108-7623		Tube Assy	2	
52	R108-7624		Tube Assy	2	
53	R108-7625		Tube Assy	2	
54	R108-7632		Tube Assy	2	
55	R108-1679		Hydraulic Hose Assy	2	
56	R108-7645		Hydraulic Hose Assy	2	
Other Parts Available					
70	R340-74		Locknut - Bulkhead	2	
71	R237-65		O-Ring	11	
72	R56-7971		Clamp - Tube	2	
73	R2412-134		R-Clamp	4	
74	R3234-4		Bolt - Hx Ser Was HD 1/4-20 x 3/4	4	
75	R301504	R32127-24, R32146-17, R3296-16, R3296-42, R915661P, RM40333	Locknut - ESNA 1/4-20	12	

All original equipment manufacturers names and part numbers are used for identification purposes only, and we are in no way implying that our products are original equipment parts. Prices subject to change without notice.



Replaces R&R Products Reel Max 744LP

Parts

*Traction Unit
Front Wheel 4WD*



Item No	R&R Part No.	OEM Part No.	Description	Qty Req	Order Quantity
76	R237-42	R31-4160, R339897	O-Ring	1	
77	R59-7410		Tip-Nipple	1	
78	R354-79		Cap-Dust	1	
79	R110-0951		Shiel D- Wheel - Rear LH	1	
80	R110-0950		Shield - Brake - Front	2	
81	R110-8878		Shield-Wheel - Rear RH	1	
82	R340-17		No 10 Male Orfs x No 10 Male Orb	4	
83	R237-80	R327-80	O-Ring	6	
84	R106-3874		Hydraulic Motor - Wheel LH	1	
85	R106-3875		Hydraulic Motor - Wheel RH	1	
86	R110-8871		Brake Assy - RH	1	
87	RF5003	3296-23, R32127-29, R32131-5, R32132-5, R3296-23, R64229-05	Locknut - ESNA 1/2-13	8	
88	R453009	3256-3, R01-166-0400, R24-10-BD, R24-9-AD, R24H1136, R32-9650, R3256-2, R3256-23, R3256-67, R3290-217, R3556-3, R4-2390, R452006, R7-0152	Washer - Flat 5/16 SAE	9	

All original equipment manufacturers names and part numbers are used for identification purposes only, and we are in no way implying that our products are original equipment parts. Prices subject to change without notice.



Replaces R&R Products Reel Max 744LP

Parts

*Traction Unit
Front Wheel 4WD*



Item No	R&R Part No.	OEM Part No.	Description	Qty Req	Order Quantity
89	R321-4	400108, R01-150-1030, R01-178-0406, R20-3-AGD, R3222-1, R400108	Bolt - Hex HD 1/4-20 x 3/4	8	
90	R3257-42		Key - Woodruff 5/16 x 1	2	
91	R110-5343-03		Bracket-Brake	2	
92	R325-11	R01-150-0330, R20-92-AGD	Bolt - Hex HD 1/2-13 x 2-3/4	8	
93	R117-0203-03		Bracket- Brake Spring	2	
94	R322-7	R01-150-0750, R01-150-0760, R01-178-0512, R20-28-AD, R20-28-AGD, R3223-4	Bolt - Hex HD 5/16-18 x 1-1/2	3	
95	RP457-2	R01-191-0518, R22-12-AJK, R3218-2, R513299, RP3015-2	Nut - Jam 5/16-18 Zinc	2	
96	R87-4020		Spring - Extension	2	
97	R283-62		Pin - Clevis 5/16 x 3/4	2	
98	R104-8300	R119-4041	Locknut - 5/16-18 Flanged Y/Zinc	3	
99	R3296-39	3296-39, R32127-25, R32128-36, R3296-17, R3296-22, R915663P, R99-7443	Locknut - 3/8-16 Nylon	8	
100	R110-8872		Brake Assy - LH	1	

All original equipment manufacturers names and part numbers are used for identification purposes only, and we are in no way implying that our products are original equipment parts. Prices subject to change without notice.



Replaces R&R Products Reel Max 744LP Parts

*Traction Unit
Front Wheel 4WD*



Item No	R&R Part No.	OEM Part No.	Description	Qty Req	Order Quantity
101	R323-6	323-6, R01-150-0010, R01-178-0608, R20-47-AD, R20-47-AGD, R3224-2, R49-3510, R908034P, R908332	Bolt - Hex HD 3/8-16 x 1 GR5 YZ	8	
102	R10-6830		Stud - Wheel 1/2-20 x 1 3/4	10	
103	R110-9046	R106-3605	Hub - Wheel	2	
104	R26-3790		Nut - Hex - Wheel Motor 1-20	2	
105	R150878		Drum - Brake - Reel Max	2	
106	R242-50		Nut - 1/2-20 Wheel	10	
107	R340-139		Hydraulic Fitting - 90 Deg	1	
108	R340-156		Hydraulic Fitting	1	
109	R237-81		O-Ring	2	

All original equipment manufacturers names and part numbers are used for identification purposes only, and we are in no way implying that our products are original equipment parts. Prices subject to change without notice.