



# Replaces R&R Products Reel Max 331LP

## Parts

*Traction Unit*

*Front Platform & Traction Control*

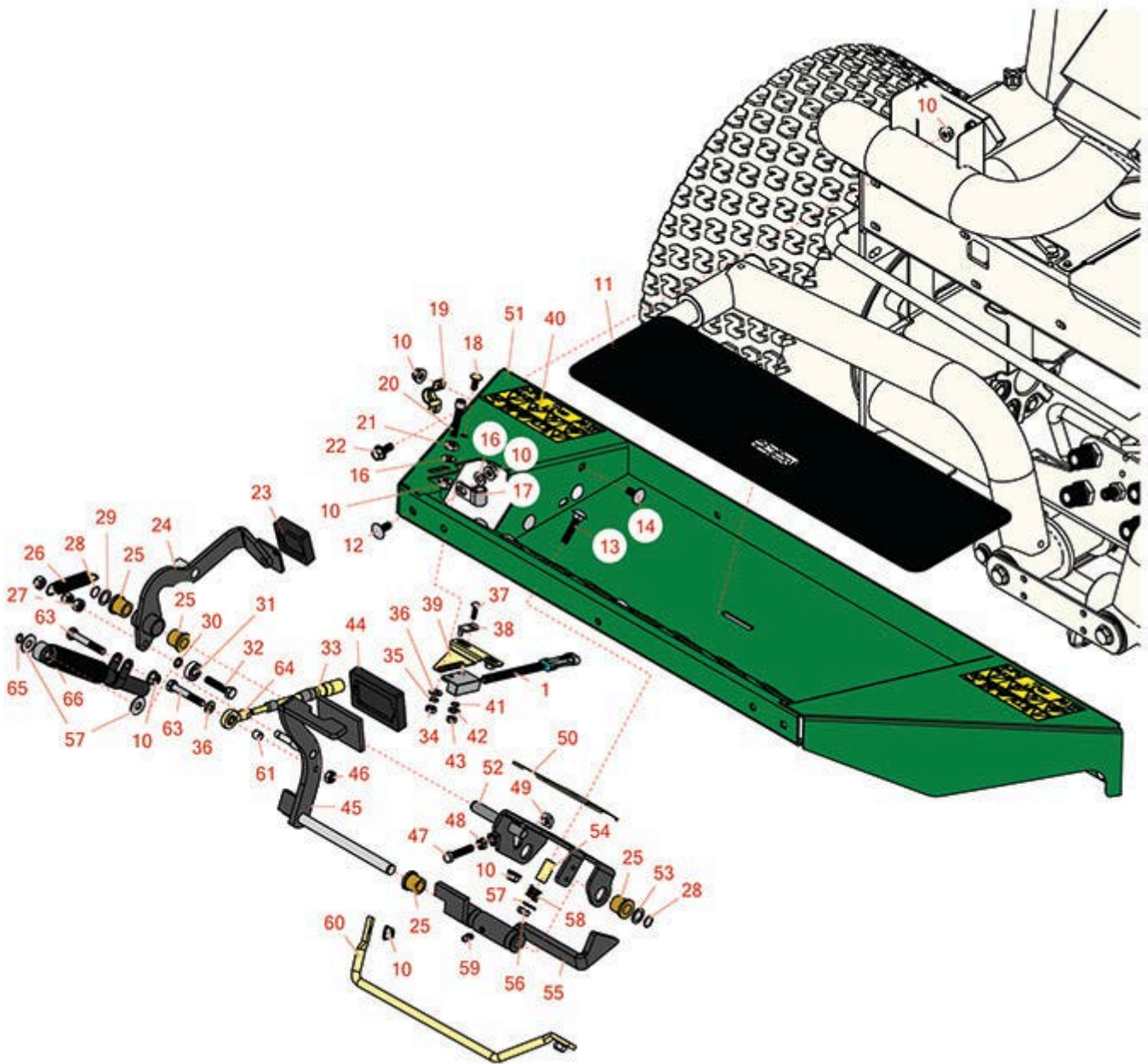

All original equipment manufacturers names and part numbers are used for identification purposes only, and we are in no way implying that our products are original equipment parts. Prices subject to change without notice.



# Replaces R&R Products Reel Max 331LP

## Parts

Traction Unit

Front Platform & Traction Control



Item No	R&R Part No.	OEM Part No.	Description	Qty Req	Order Quantity
---------	--------------	--------------	-------------	---------	----------------

### Gauges and Controls

1	<b>R100-1270</b>		Sensor - Proximity	1	
---	------------------	--	--------------------	---	--

### Other Parts Available

10	<b>R445722</b>	R30-8980, R32128-2, R32128-20	Nut - Serrated Washer	22	
11	<b>R99-3478</b>		Pad - Anti Skid	1	
12	<b>R3230-23</b>	R3-5861	Bolt - 5/16-18x3/4 - Carriage	5	
13	<b>R3230-6</b>		Bolt - Carraige	1	
14	<b>R112-6950</b>	R3230-27	Bolt - Carriage 5/16-18 x 1-1/2	3	
16	<b>R453009</b>	3256-3, R01-166-0400, R24-10-BD, R24-9-AD, R24H1136, R32-9650, R3256-2, R3256-23, R3256-67, R3290-217, R3556-3, R4-2390, R452006, R7-0152	Washer - Flat 5/16 SAE	3	
17	<b>R2412-103</b>		Clamp	1	
18	<b>R3229-1</b>	R01-173-0406, R01-178-0408, R3229-25, R900015P	Bolt - 1/4-20 x 3/4 - Carriage	2	
19	<b>R93-2092</b>		Clamp - Cable	1	
20	<b>R330748</b>	R3274-22	Screw - 5/16-18x1 Socket HD	1	

All original equipment manufacturers names and part numbers are used for identification purposes only, and we are in no way implying that our products are original equipment parts. Prices subject to change without notice.



# Replaces R&R Products Reel Max 331LP Parts

*Traction Unit  
Front Platform & Traction Control*



Item No	R&R Part No.	OEM Part No.	Description	Qty Req	Order Quantity
21	<b>R443106</b>	3218-2, 443106, R01-188-0518, R09003, R22-12-AJD, R32111-4, R3217-4, R3217-6, R513295, R513412, R915112P, R915978, R915979	Nut - 5/16-18 Y/Zinc Plated	1	
22	<b>R3234-5</b>	R62-3310	Bolt - 5/16-18x3/4 Hx Ser Was HD	11	
23	<b>R74-9110</b>		Rubber Foot Pad - Reverse	1	
24	<b>R99-3379</b>		Pedal - Reverse	1	
25	<b>R256-243</b>		Bearing - Flange	4	
26	<b>R99-3476</b>		Spring - Extension	1	
27	<b>R3296-47</b>		Locknut - 5/16-18 Jam Nyloc	3	
28	<b>R32151-84</b>	R32120-3, R32120-80	Ring - Shaft - Ext	2	
29	<b>R455012</b>	R41-8440	Washer - Flat 1/2 x 3/4	1	
30	<b>R75-5470</b>		Spacer - Bearing	1	
31	<b>R251-259</b>	R251-307	Bearing - Ball	1	
32	<b>R322-7</b>	R01-150-0750, R01-150-0760, R01-178-0512, R20-28-AD, R20-28-AGD, R3223-4	Bolt - Hex HD 5/16-18 x 1-1/2	1	
33	<b>R107-2084</b>		Traction Cable Assy	1	

All original equipment manufacturers names and part numbers are used for identification purposes only, and we are in no way implying that our products are original equipment parts. Prices subject to change without notice.



# Replaces R&R Products Reel Max 331LP Parts

*Traction Unit  
Front Platform & Traction Control*



Item No	R&R Part No.	OEM Part No.	Description	Qty Req	Order Quantity
34	<b>R443102</b>	R01-188-0420, R22-11-AJD, R3217-5	Nut - 1/4-20 Yellow Zinc	2	
35	<b>R3255-7</b>	R76-5310	Washer - Lock 1/4 Ext Star Z	2	
36	<b>R3256-22</b>	R09061, R24-9-BD, R3-1032, R93-0954, R93-0989	Washer - Flat 1/4 Yellow	3	
37	<b>R3229-20</b>		Screw - 3/16-24 x 3/4 Carr	1	
38	<b>R100-4872</b>	R104-7702	Plate-Switch - Neutral	1	
39	<b>R100-4871</b>		Bracket - Neutral Switch	1	
40	<b>R104-5181</b>	R99-3560	Decal- Danger	2	
41	<b>R3256-14</b>	R24-7-BD, R297-3, R32125-2, R3256-51, R51-2170	Washer - 10 Flat	1	
42	<b>R3255-17</b>		Washer - Lock - Ext	1	
43	<b>R3296-2</b>	R32127-10, R9157404	Nut - #10 Lock	1	
44	<b>R74-9100</b>		Rubber Foot Pad - Forward	1	
45	<b>R104-4852-03</b>	R99-3564	Traction Pedal Assy	1	
46	<b>R301504</b>	R32127-24, R32146-17, R3296-16, R3296-42, R915661P, RM40333	Locknut - ESNA 1/4-20	1	
47	<b>R322-41</b>		Bolt - Hx HD	1	

All original equipment manufacturers names and part numbers are used for identification purposes only, and we are in no way implying that our products are original equipment parts. Prices subject to change without notice.



# Replaces R&R Products Reel Max 331LP Parts

*Traction Unit  
Front Platform & Traction Control*



Item No	R&R Part No.	OEM Part No.	Description	Qty Req	Order Quantity
48	<b>RP457-2</b>	R01-191-0518, R22-12-AJK, R3218-2, R513299, RP3015-2	Nut - Jam 5/16-18 Zinc	1	
49	<b>R99-3565</b>		Nut - Square	1	
50	<b>R106-2661-01</b>		Plate - Support	1	
51	<b>R106-4154G</b>		Floorplate	1	
52	<b>R95-8869-03</b>	R95-8869	Bracket - Traction Pedal	1	
53	<b>R73-0040</b>		Washer - Thrust	1	
54	<b>R95-8866</b>		Tube- Rocker Arm	1	
55	<b>R95-8861</b>		Slide	1	
56	<b>R3296-29</b>	3296-29, R1-804256, R915662P	Locknut - 5/16-18 ESNA	1	
57	<b>R453011</b>	3256-24, 453011, R01-166-0100, R01-166-0120, R01-166-0270, R01-166-0500, R01-166-0600, R01-166-0620, R132-4593, R237-12, R24-10-AD, R24-11-AD, R24-11-BD, R24-12-AD, R24-12-BD, R30-9310, R32-8190, R3256-24, R3256-3, R3256-36, R3256-4, R47-9950	Washer - Flat 3/8 SAE Y/Zinc	3	

All original equipment manufacturers names and part numbers are used for identification purposes only, and we are in no way implying that our products are original equipment parts. Prices subject to change without notice.



# Replaces R&R Products Reel Max 331LP Parts

*Traction Unit  
Front Platform & Traction Control*



Item No	R&R Part No.	OEM Part No.	Description	Qty Req	Order Quantity
58	<b>R65-9940</b>		Spring	1	
59	<b>R302-5</b>	R173-0, R21-6010, R255825, R302-37, R302-47, R302-57, R302-58, R302-6, R31-0300, R32-9660, R471214, R471223, R471226, R60-0800, R62-3880, R92-4181, RJD7797, RJD7842, RJD7844, RM0004	Fitting - Grease	1	
60	<b>R95-8893</b>		Bar - Deflector	1	
61	<b>R99-3545</b>		Spacer	1	
63	<b>R322-10</b>	R20-30-AD, R24-7180, R3223-6, R513347	Bolt - Hex HD 5/16-18 x 2	2	
64	<b>R2411-41</b>		Rod End - Ball Joint	1	
65	<b>R32151-3</b>		Ring - Grip	1	
66	<b>R76-8870</b>	R105-7280	Lever Damper Assy	1	

All original equipment manufacturers names and part numbers are used for identification purposes only, and we are in no way implying that our products are original equipment parts. Prices subject to change without notice.