

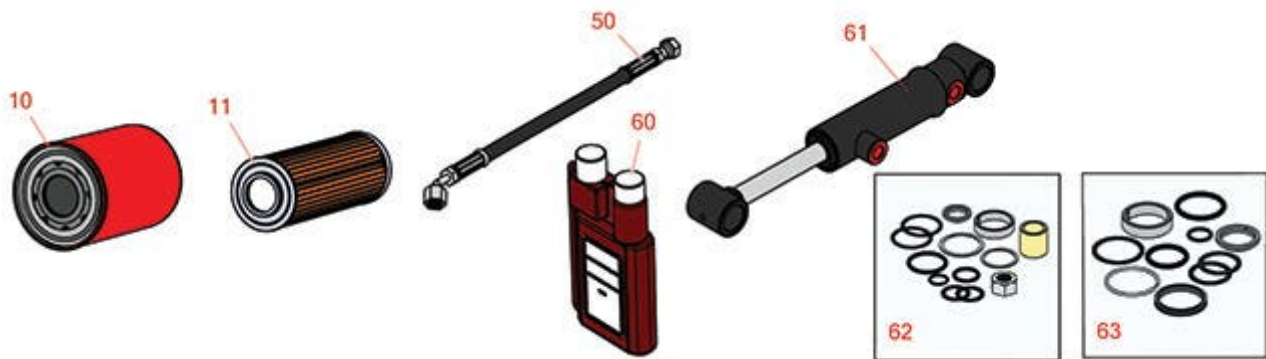

# Replaces Jacobsen LF-128 Parts

Traction Unit  
Hydraulics



All original equipment manufacturers names and part numbers are used for identification purposes only, and we are in no way implying that our products are original equipment parts. Prices subject to change without notice.



# Replaces Jacobsen LF-128 Parts

Traction Unit  
Hydraulics



Item No	R&R Part No.	OEM Part No.	Description	Qty Req	Order Quantity
---------	--------------	--------------	-------------	---------	----------------

## Filters

10	R554630	551135, 554630, 558022	Filter - Oil	1	
11	R556416	556416	Element - Cartridge Hyd	1	

## Hoses

50	R132038	132038	Hydraulic Hose Assy	1	
50	R132045	132045	Hydraulic Hose Assy	2	
50	R132046	132046	Hydraulic Hose Assy	1	
50	R132056	132056	Hydraulic Hose Assy	1	
50	R132063	132063	Hydraulic Hose Assy	1	
<i>Detail Description: Fits Dual Reel Pump to Solenoid Valve:</i>					
50	R132064	132064	Hydraulic Hose Assy	1	
<i>Detail Description: Fits Dual Reel Pump to Solenoid Valve:</i>					
50	R132066	132066	Hydraulic Hose Assy	1	
50	R132067	132067	Hydraulic Hose Assy	1	
50	R132068	132068	Hydraulic Hose Assy	1	
50	R132069	132069	Hydraulic Hose Assy	1	
50	R132614	132074	Hydraulic Hose Assy	1	
50	R132613	132075	Hydraulic Hose Assy	1	
50	R132609	132076	Hydraulic Hose Assy	1	
50	R132610	132077	Hydraulic Hose Assy	1	
50	R132604	132078	Hydraulic Hose Assy	1	

All original equipment manufacturers names and part numbers are used for identification purposes only, and we are in no way implying that our products are original equipment parts. Prices subject to change without notice.



## Replaces Jacobsen LF-128 Parts

Traction Unit  
Hydraulics



Item No	R&R Part No.	OEM Part No.	Description	Qty Req	Order Quantity
50	<b>R132606</b>	132079	Hydraulic Hose Assy	1	
50	<b>R132608</b>	132080	Hydraulic Hose Assy	1	
50	<b>R132090</b>	132090	Hydraulic Hose Assy	1	
50	<b>R132145</b>	132145	Hydraulic Hose Assy	1	
50	<b>R132160</b>	132160	Hydraulic Hose Assy	1	
<i>Detail Description: FITS REAR CYLINDERS RETURN TO LIFT VALVES:</i>					
50	<b>R132161</b>	132161	Hydraulic Hose Assy	1	
50	<b>R364961</b>	364961	Hydraulic Hose Assy	1	
50	<b>R364962</b>	364962	Hydraulic Hose Assy	1	
50	<b>R364968</b>	364968	Hydraulic Hose Assy	1	
50	<b>R364969</b>	364969	Hydraulic Hose Assy	1	
50	<b>R554751</b>	554751	Hose - Fuel 1/4 in 10 ft	0	
50	<b>R132071</b>	132071	Hydraulic Hose Assy	2	
50	<b>R132072</b>	132072	Hydraulic Hose Assy	1	
50	<b>R132073</b>	132073	Hydraulic Hose Assy	1	
50	<b>R132060</b>	132060	Hydraulic Hose Assy	1	
50	<b>R132061</b>	132061	Hydraulic Hose Assy	1	
50	<b>R132058</b>	132058	Hydraulic Hose Assy	1	
50	<b>R132057</b>	132057	Hydraulic Hose Assy	1	
50	<b>R132070</b>	132070	Hydraulic Hose Assy	1	
<i>Detail Description: Includes 2 ea R132071, &amp; 1ea. R132072 &amp; R132073:</i>					
50	<b>R132159</b>	132159	Hydraulic Hose Assy	1	

All original equipment manufacturers names and part numbers are used for identification purposes only, and we are in no way implying that our products are original equipment parts. Prices subject to change without notice.



# Replaces Jacobsen LF-128 Parts

Traction Unit  
Hydraulics



Item R&R  
No Part No.

OEM  
Part No.

Description

Qty  
Req

Order  
Quantity

*Detail Description: Includes 2 ea R132071, & 1ea. R132072 & R132160:*

## Cylinders

60	<b>R525-16</b>		Hydraulic Oil Dye - 16 oz	0
----	----------------	--	---------------------------	---

*Detail Description: Red dye provides leak detection and color coding for oils, synthetic oils, fats, waxes, resins and most solvents. Free from any insolubles. Concentrate. Use 1/2 oz. per 5 Gallons of oil. 16 oz bottle.:*

61	<b>R132032</b>	132032	Hydraulic Cylinder	3
----	----------------	--------	--------------------	---

61	<b>R132033</b>	132033	Hydraulic Cylinder	2
----	----------------	--------	--------------------	---

62	<b>R554759</b>	554759	Seal Kit - Fits R132032 Cylinder	1
----	----------------	--------	----------------------------------	---

63	<b>R554760</b>	554760	Seal Kit - Fits R132033 Cylinder	1
----	----------------	--------	----------------------------------	---

All original equipment manufacturers names and part numbers are used for identification purposes only, and we are in no way implying that our products are original equipment parts. Prices subject to change without notice.