

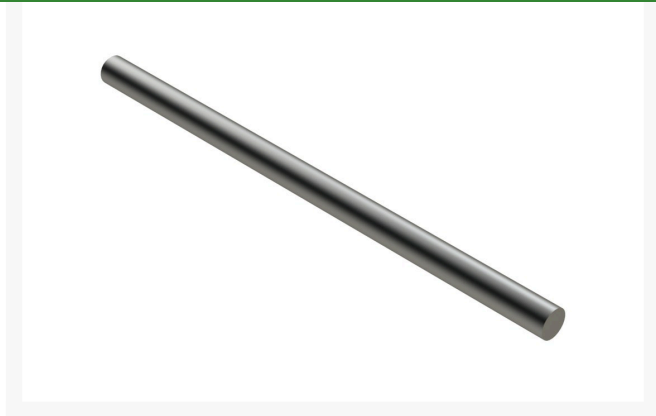

Alloy Solid Needle Tine - .197MT x 3.500L x .197OD R201422



Details

Alloy Solid Tines aerate without the work of cleaning up the mess of cores and debris left behind with conventional core aerating. R&R Solid Tines are manufactured from a special high-carbon steel bar and heat treated to RC45-48 in our own heat treatment facility. They are available in all standard sizes but are especially popular in the smaller diameters for aerating in the summer months to relieve the stress on greens by allowing water, air and nutrients to easily flow into the root zone. With the combination of small holes and no cores, play can be resumed immediately.

Specifications

Manufacturer	R&R Products
A - Tine Type	Alloy Solid Needle
B - Tine Mounting Dia.	.197 in (5mm)
C - Tine Length	3.5 in (89mm)
D - Tine Tip Outside (Hole) Dia.	.197 in (5mm)

Fits Models

Jacobsen GA-24
Ryan GA30
Ryan Greensaire II
Toro Greens Aerator

Gritmaster

309 Percy Osborn Road Morningside, 4001
0313035785

<https://gritmaster.rrproducts.com/>