

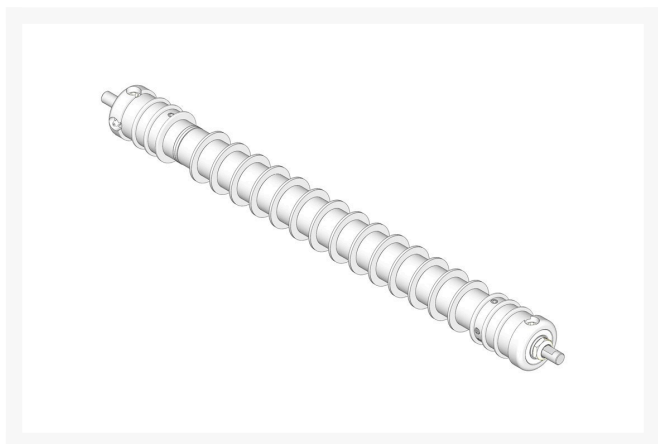

# Roller - Grooved Repairable Steel

## RLMAA356RG



### Details

Constructed with a through shaft and greasable tapered bearings for extended life, this roller can be repaired by unscrewing the ends and replacing the series of washers and spacers. Body Length: 27-1/2" & Shaft Length: 31-3/4"

### Replaces

R&R Products	RLMAA356G
--------------	-----------

### Specifications

Manufacturer	R&R Products
Overhaul Kit No.	R100135
Roller Body	2.75 in
Diameter	
Weight	20 lb

### Fits Models

Ransomes 213, 350 & 5/7 Fairway

### Replacement Parts

R100135	Overhaul Kit - Roller
R500534	Bearing - with Cup
R150670	Roller End - 2-3/4 Threaded
R328059	Shaft - Grooved Roller
R150672	Washer - 2-3/4 Roller
R150676	Spacer - 2-3/4 Dia x 1-1/4 L
R150678	Spacer - Grooved Roller 3/4
R150676A	Spacer - 1/8
R150691	Screw - Set Nyloc

**Gritmaster**

309 Percy Osborn Road Morningside, 4001  
0313035785

<https://gritmaster.rrproducts.com/>



# Roller - Grooved Repairable Steel

RLMAA356RG



	3/8-16 x 3/8
R170714	Fitting - Pressure Relief
R302-5	Fitting - Grease
R253-122	Seal
R254-79	Cup - Bearing
R254-78	Tapered Bearing Cone
R150674	Sleeve - Wear 3/4 Plated
R253-117	Seal - Outer Triple Lip
R3296-15	Locknut - 3/4-16 Nylon Jam

## Gritmaster

309 Percy Osborn Road Morningside, 4001  
0313035785

<https://gritmaster.rrproducts.com/>