

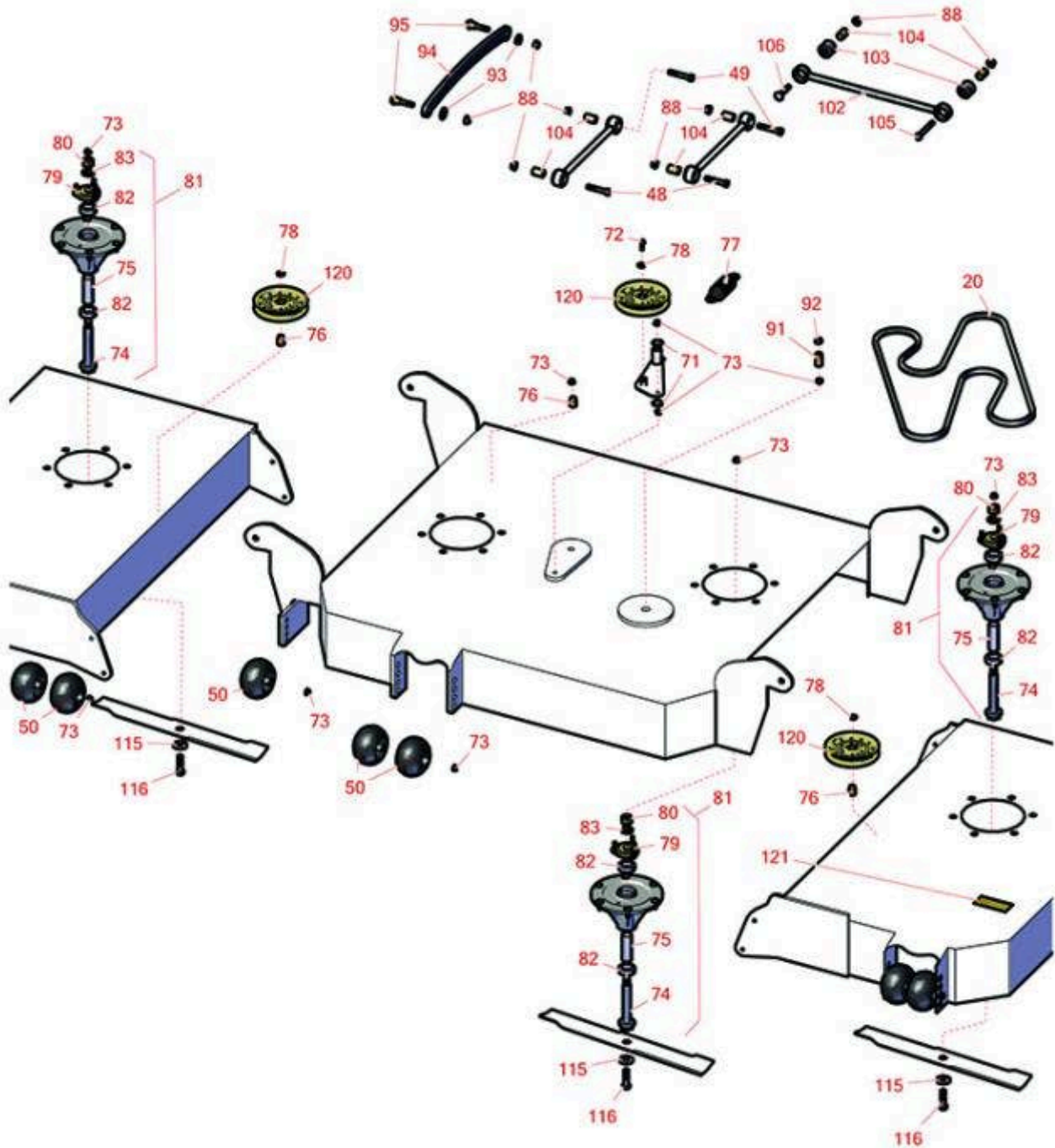

Replaces Toro Z Master Professional 7500-G Parts

Zero-Turn Mower with 96in Deck - Model 74096
96in Rotary Deck



All original equipment manufacturers names and part numbers are used for identification purposes only, and we are in no way implying that our products are original equipment parts. Prices subject to change without notice.



Replaces Toro Z Master Professional 7500-G Parts

Zero-Turn Mower with 96in Deck - Model 74096
96in Rotary Deck



Item No	R&R Part No.	OEM Part No.	Description	Qty Req	Order Quantity
Belts					
20	R126-6442	126-6442	Belt-V	1	
Other Parts Available					
48	R325-11	01-150-0330, 20-92-AGD, 325-11, 325-9	Bolt - Hex HD 1/2-13 x 2-3/4	2	
49	R325-12	01-150-0320, 01-150-0880, 01-178-0824, 20-93-AD, 325-12	Bolt - Hx HD	2	
50	R103-8415	103-8415	Roller - Anti Scalp	9	
71	R106-7159	106-7159	O-Ring	2	
72	R3234-42	3234-42	Bolt - 3/8-16 x 1 Hx HD Fl	1	
73	R104-8301	104-8301, 104-9301, 109-6658, 133-7570	Locknut - 3/8-16 Nylon Flanged	45	
74	R127-0556	127-0556	Shaft- Spindle	4	
75	R127-0554	127-0554	Spacer - Bearing	4	
76	R1-633456	1-633456	Bushing - Idler	6	
77	R116-6317	116-0133, 116-6317	Spring - Extension	3	
78	R98-5975	98-5975	Washer - Belleville	16	
79	R127-0557	127-0557	Spindle Hub Assy w/Studs	4	
80	R3296-67	3296-67	Locknut - 3/4-16 Heavy Jam RH Thread	6	
81	R127-0560	127-0560	Spindle Assy - No Grease	4	

All original equipment manufacturers names and part numbers are used for identification purposes only, and we are in no way implying that our products are original equipment parts. Prices subject to change without notice.



Replaces Toro Z Master Professional 7500-G Parts

Zero-Turn Mower with 96in Deck - Model 74096
96in Rotary Deck



Item No	R&R Part No.	OEM Part No.	Description	Qty Req	Order Quantity
82	R116-0720	116-0720	Bearing - Ball - Special Triple Seal	8	
83	R92-5836	92-5836	Flat Washer - Hardened	4	
88	R32128-23	32128-23, 3218-23, 99-5107	Nut - Lock Hex Flanged 1/2-13	16	
91	R109-7840	109-7840	Adjuster - Lift - Deck	4	
92	R443818	01-191-0813, 3218-18, 3218-5	Nut - 1/2-13 Hex Jam Zinc	4	
93	R453022	01-166-0480, 01-166-1220, 21-3880, 217-21, 30-8550, 30-9110, 3256-28, 3256-44, 46-9030, Mar-71	Washer - 3/4 SAE	2	
94	R116-0797-03	116-0797-03	Link-Lift - Deck	1	
95	R116-2022	116-2022	Shoulder Bolt - Flanged Hex Head	2	
102	R109-5013	109-5013	Panhard Rod Assy	1	
103	R109-5009	109-5009	Bushing - Suspension - Rubber	2	
104	R109-5010	109-5010	Spacer	6	
105	R325-17	01-150-0640, 01-150-0850, 01-178-0832, 01-178-0836, 20-97-AGD, 325-17, 325-18, 48-9260	Bolt - Hex Head	1	
106	R3233-34	3233-34	Carriage Bolt - 1/2-13 x 2 1/2 Grade 5	1	

All original equipment manufacturers names and part numbers are used for identification purposes only, and we are in no way implying that our products are original equipment parts. Prices subject to change without notice.



Replaces Toro Z Master Professional 7500-G Parts

*Zero-Turn Mower with 96in Deck - Model 74096
96in Rotary Deck*



Item No	R&R Part No.	OEM Part No.	Description	Qty Req	Order Quantity
115	R103-0865	103-0865	Washer - Blade Bolt HD	4	
116	R51-4060	51-4060	Bolt - Blade	4	
120	R116-4667	116-4667, 126-7685	Idler -Pulley - Flat	2	
121	R93-7818	93-7818	Decal - Blade Torque	1	

All original equipment manufacturers names and part numbers are used for identification purposes only, and we are in no way implying that our products are original equipment parts. Prices subject to change without notice.