

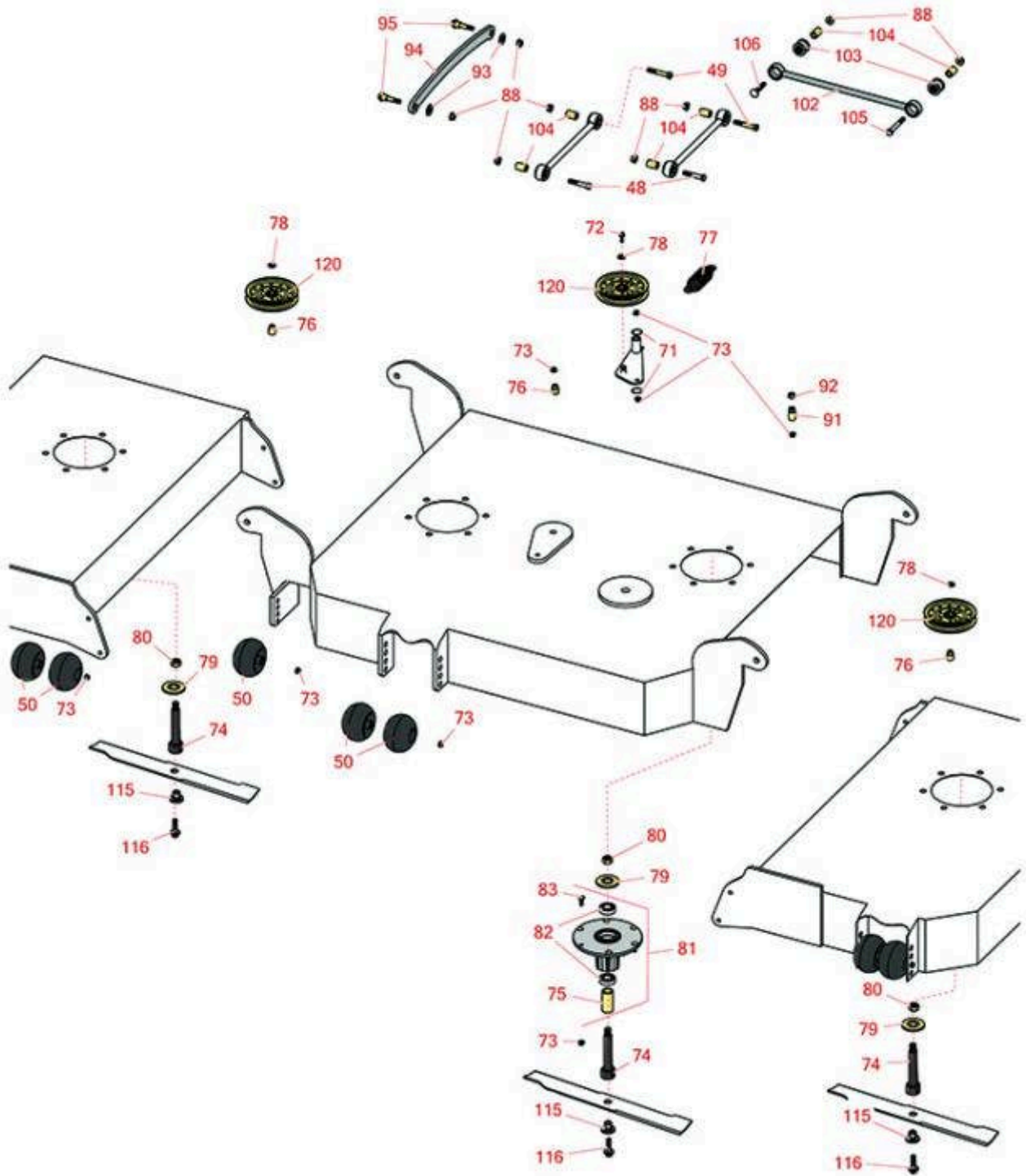

# Replaces Toro Z Master Professional 7500-D Parts

Zero-Turn Mower with 96in Deck - Model 72096  
96in Rotary Deck



All original equipment manufacturers names and part numbers are used for identification purposes only, and we are in no way implying that our products are original equipment parts. Prices subject to change without notice.



# Replaces Toro Z Master Professional 7500-D Parts

Zero-Turn Mower with 96in Deck - Model 72096  
96in Rotary Deck



Item No	R&R Part No.	OEM Part No.	Description	Qty Req	Order Quantity
---------	--------------	--------------	-------------	---------	----------------

## Other Parts Available

48	<b>R325-11</b>	01-150-0330, 20-92-AGD, 325-11, 325-9	Bolt - Hex HD 1/2-13 x 2-3/4	2	
49	<b>R325-12</b>	01-150-0320, 01-150-0880, 01-178-0824, 20-93-AD, 325-12	Bolt - Hx HD	2	
50	<b>R103-8415</b>	103-8415	Roller - Anti Scalp	9	
71	<b>R106-7159</b>	106-7159	O-Ring	2	
72	<b>R3234-42</b>	3234-42	Bolt - 3/8-16 x 1 Hx HD Fl	1	
73	<b>R104-8301</b>	104-8301, 104-9301, 109-6658, 133-7570	Locknut - 3/8-16 Nylon Flanged	45	
74	<b>R138-6045</b>	138-6045	Shaft - Spindle	4	
75	<b>R138-6042</b>	138-6042	Spacer-Bearing	4	
76	<b>R1-633456</b>	1-633456	Bushing - Idler	6	
77	<b>R116-6317</b>	116-0133, 116-6317	Spring - Extension	3	
78	<b>R98-5975</b>	98-5975	Washer - Belleville	16	
79	<b>R103-1330</b>	103-1330	Guard - Bearing - Top	4	
80	<b>R116-7306</b>		Hex Nut - 3/4-16 with Nyloc	6	
81	<b>R137-9780</b>	137-9780	Spindle Assy	4	
82	<b>R116-0720</b>	116-0720	Bearing - Ball - Special Triple Seal	8	

All original equipment manufacturers names and part numbers are used for identification purposes only, and we are in no way implying that our products are original equipment parts. Prices subject to change without notice.



# Replaces Toro Z Master Professional 7500-D Parts

Zero-Turn Mower with 96in Deck - Model 72096  
96in Rotary Deck



Item No	R&R Part No.	OEM Part No.	Description	Qty Req	Order Quantity
83	<b>R114-8195</b>	114-8195, R & R ONLY	Bolt- Ribbed Neck	24	
88	<b>R32128-23</b>	32128-23, 3218-23, 99-5107	Nut - Lock Hex Flanged 1/2-13	16	
91	<b>R109-7840</b>	109-7840	Adjuster - Lift - Deck	4	
92	<b>R443818</b>	01-191-0813, 3218-18, 3218-5, 3248-18	Nut - 1/2-13 Hex Jam Zinc	4	
93	<b>R453022</b>	01-166-0480, 01-166-1220, 21-3880, 217-21, 30-8550, 30-9110, 3256-28, 3256-44, 46-9030, Mar-71	Washer - 3/4 SAE	2	
94	<b>R116-0797-03</b>	116-0797-03	Link-Lift - Deck	1	
95	<b>R116-2022</b>	116-2022	Shoulder Bolt - Flanged Hex Head	2	
102	<b>R109-5013</b>	109-5013	Panhard Rod Assy	1	
103	<b>R109-5009</b>	109-5009	Bushing - Suspension - Rubber	2	
104	<b>R109-5010</b>	109-5010	Spacer	6	
105	<b>R325-17</b>	01-150-0640, 01-150-0850, 01-178-0832, 01-178-0836, 20-97-AGD, 325-17, 325-18, 48-9260	Bolt - Hex Head	1	
106	<b>R3233-34</b>	3233-34	Carriage Bolt - 1/2-13 x 2 1/2 Grade 5	1	

All original equipment manufacturers names and part numbers are used for identification purposes only, and we are in no way implying that our products are original equipment parts. Prices subject to change without notice.



# Replaces Toro Z Master Professional 7500-D Parts

*Zero-Turn Mower with 96in Deck - Model 72096  
96in Rotary Deck*



Item No	R&R Part No.	OEM Part No.	Description	Qty Req	Order Quantity
115	<b>R137-9787</b>	137-9787	Bushing - Hex	4	
116	<b>R109-9220</b>	109-9220	Bolt - Sems 1/2-20	4	
120	<b>R116-4667</b>	116-4667, 126-7685	Idler -Pulley - Flat	2	

All original equipment manufacturers names and part numbers are used for identification purposes only, and we are in no way implying that our products are original equipment parts. Prices subject to change without notice.